



ROUND 2

01/06/2021

**GRANT COUNTY
CYBERMILL**

LOGO +

SENECA PROGRAMMING

Logo + Seneca Programming

- Finalization of selected logo direction
- Application of selected color on logo
- Logo application: black only, 1 + 2 color versions
- Finalization of secondary logo
- Primary + secondary icons
- Finalization of color and material palette
- Finalization of Seneca space plan
- Detailing of signature and signage elements
- Furniture program overview and selection criteria
- Test fit of John Day and Prairie City



LOGO: One Color PMS 5467





LOGO: Two-Color PMS 173U + PMS 5467U





LOGO + IDENTITY: Black Only Version





LOGO + IDENTITY: One Color PMS 5467





LOGO + IDENTITY: Two-Color PMS 124U + PMS 5467U



LOGO + IDENTITY: Secondary Logo "M" Bug





LOGO: One Color PMS 5467



LOGO + IDENTITY: Secondary Icon Family



WIFI

THE WIFI SYMBOL IS PART OF THE BRAND LOGO AND CAN BE USED SPARINGLY IN OTHER GRAPHIC APPLICATION

PRIMARY ICONS

THESE ARE THE KEY AMMENITIES WE WANT TO BROADCAST



24/7 ACCESS



AMENITIES



PRINTING



CONNECT

SECONDARY ICONS

THESE SECONDARY ICONS CAN BE UTILIZED IN ADDITION TO THE PRIMARY ICONS WHERE ROOM ALLOWS



POWER



NETWORKING



TECHNOLOGY



MEET



MATERIALS PALETTE

Pantone Colors

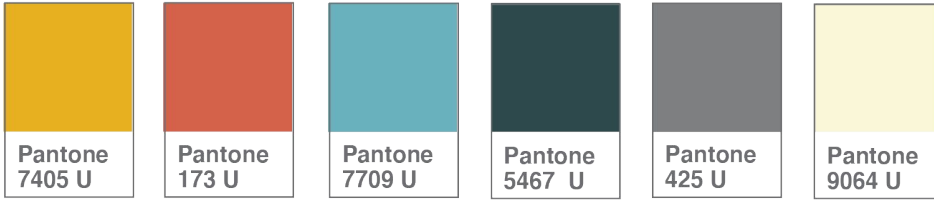

Pratt & Lambert Paint Colors

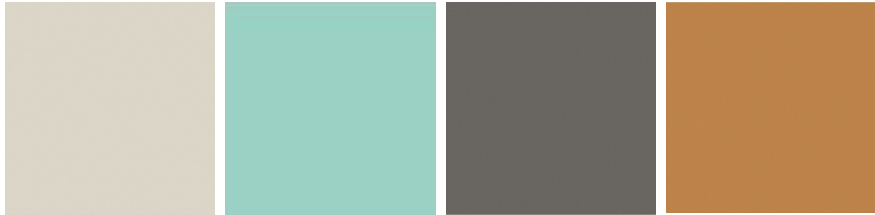

Wood



Flooring Suggestions (light & neutral)



Concrete



Vinyl Plank



Mild Steel Plate



Galvanized Sheet

SOFT LOUNGE SEATING: Inviting and comfortable for all ages and sizes. Ideally: leather or naugahyde + wood (easy to clean). Avoid fabric and paint.



SIDE + COFFEE TABLES: Wood or wood with dark metal. Keep the forms as simple as possible. Avoid painted wood, glass and plastic and ornamentation.

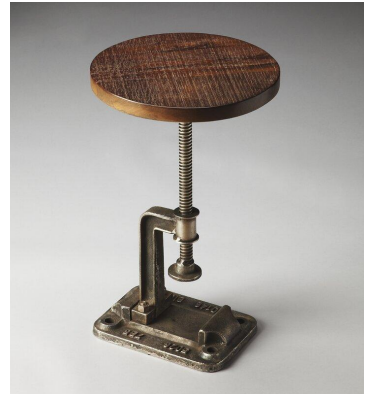
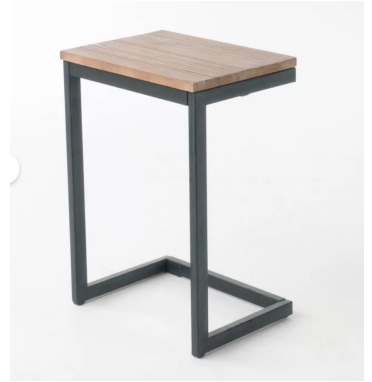

AREA RUGS: Consider native materials: wools, cottons, cowhide etc. that integrate with the overall palette of the space. Consider colors, patterns and “wear” that reflect the character and history of the area. Size is important: see plan and budget matrix for recommendations.

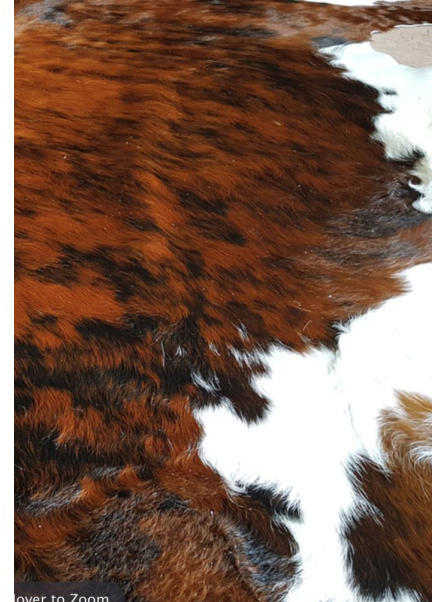

BARSTOOL SEATING: Inviting and comfortable for all ages and sizes. Durable and easy care materials. Opportunity to add some personality to the space.
Avoid fabrics.



DESK SEATING: Task and workstation chairs should all be adjustable. Consider upholstered bottoms/backs for comfort and acoustic control. Should be durable and easy to clean.



CONFERENCE SEATING: Not required to be adjustable. Think more like something for the “kitchen table”.



COLLABORATION + CONFERENCE TABLES: Simple timeless forms in natural wood. These examples are all “dining room” tables. Circular collaboration tables should have a single pedestal base for ease of configuration and use. Avoid painted wood and glass. **WORKSTATION TABLES:** “Mini desks” in wood.



Workstation example above

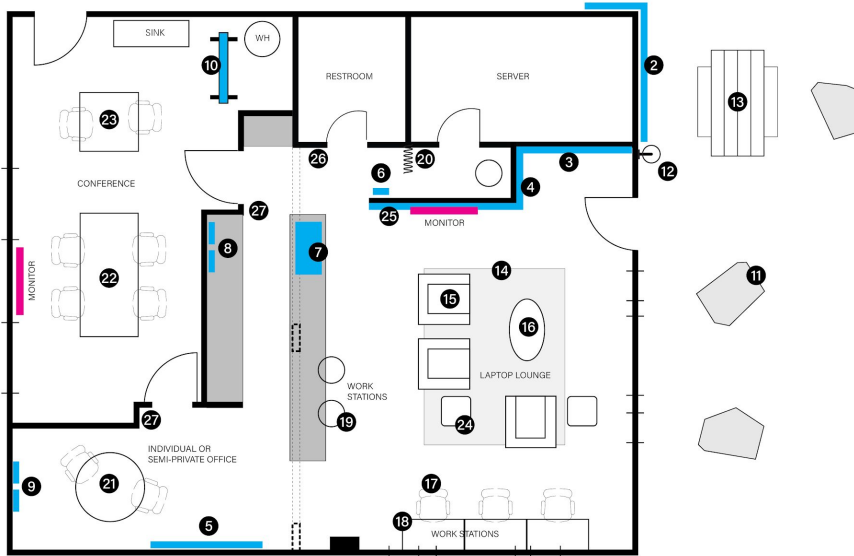

1 | FLOOR PLAN: Seneca

Number	Component	Description	Quantity	Budget	Budget
1	Site Sign	Mounts to existing pole. Add "Porch" light fixture to front of sign	1	\$2,500.00	
2	Building Branding	Painted ID + icons on siding	1	\$1,500.00	
3	Community + Events Board	Magnetic, identifies all sites	1	\$1,500.00	
4	Welcome + message board	Paper roll panel	1	\$700.00	
5	Thematic backdrop / artwork	Acoustic control artwork	1	\$1,500.00	
6	Phone Booth ID	9 x 15 clipboard panel with message	1	\$200.00	
7	Program Hub	Countertop organizer for pens, pencils, pencil sharpener and program specific flyers	1	\$600.00	
8	Partner / Sponsor ID	23 x 26 clipboard panel with message	2	\$400.00	
9	Community Art or Scribble Panel	23 x 26 clipboard panel	2	\$350.00	
10	Write Board Uline.com	3' x 4' Metal Porcelain + rollable	1		\$600.00
10b	Write Board Branding	1/4" thk. plywood graphic ID element		\$350.00	
11	Boulders	Boulder, Log Stump or Industrial artifact. Car barrier + seating	3		\$500.00
12	Porch Light	Home Depot Barn style. One for the back side of the site sign	2		\$250.00
13	Picnic Table	Could be patio table and outdoor chairs	1		\$300.00
14	Area Rug	Drawn at 8' x 10' (Minimum)	1		\$300.00
15	Lounge Chairs	Soft Seating. Durable + cleanable	3		\$900.00
16	Coffee Table	Wood 42" x 24" (Oval is ideal)	1		\$200.00
17	Office Chairs		11		\$2,200.00
18	Workstation Desks	24" x 42"	3		\$900.00
19	Bar Stools	Two comfortable with backs, one "stool" for the phone booth	3		\$600.00
20	"Phone Booth" Curtain	Closes to create phone booth "privacy" and mitigate sound. Curtain + ceiling track (added \$200 for install) https://roomdividersnow.com/products/ceiling-track-room-divider-kits?variant=16602650950	1		\$450.00
21	Work Table	Wood 48" diameter. Ideal with single support base	1		\$250.00
22	Conference Table A	40" x 72 - 84" (max 40" width)	1		\$200.00
23	Conference Table B	40" x 40"	1		\$200.00
24	Side Tables	20" x 20" (max)	2		\$200.00
25	Monitor Cable Hanger	Cut-out metal logo "bug" + leather strap to secure USB + HDMI cords		\$500.00	
26	Restroom ID	Photopolymer Plaque with Braille	1	\$200.00	
27	Conference Room ID	Photopolymer Plaque with Braille + clipboard	2	\$250.00	
				\$10,550.00	\$8,050.00

PROGRAMMING: Writeboard + Space Configurations

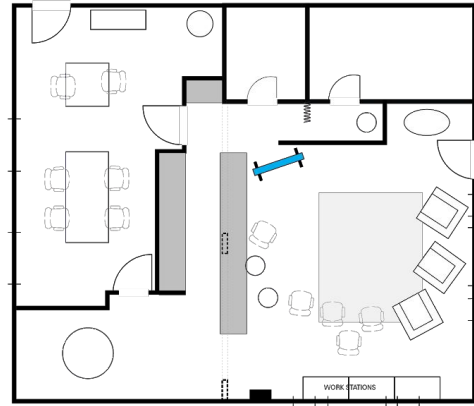
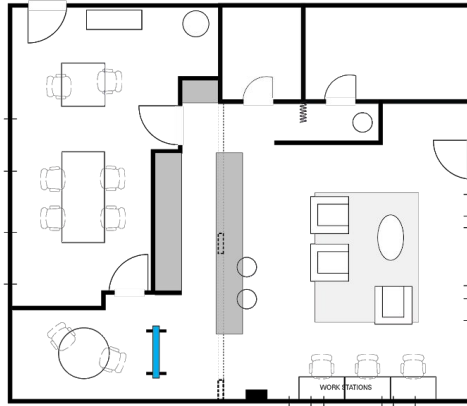
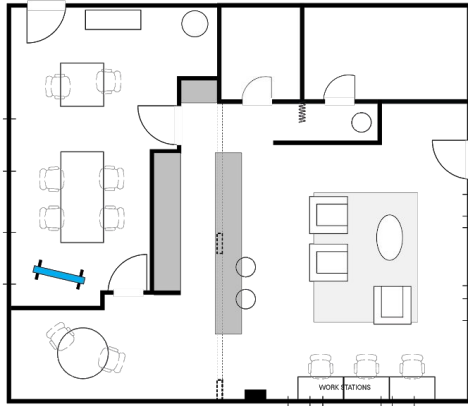

EVENT MODE

1 | WRITE BOARD USAGE
1/8" = 1'-0"

BUILDING BRANDING: Painted sign and logo graphics on building siding



1 | EXTERIOR ELEVATION: Entry
1/2" = 1'-0"

SITE SIGN: New sign framework, sign panel and barn light on existing sign pole

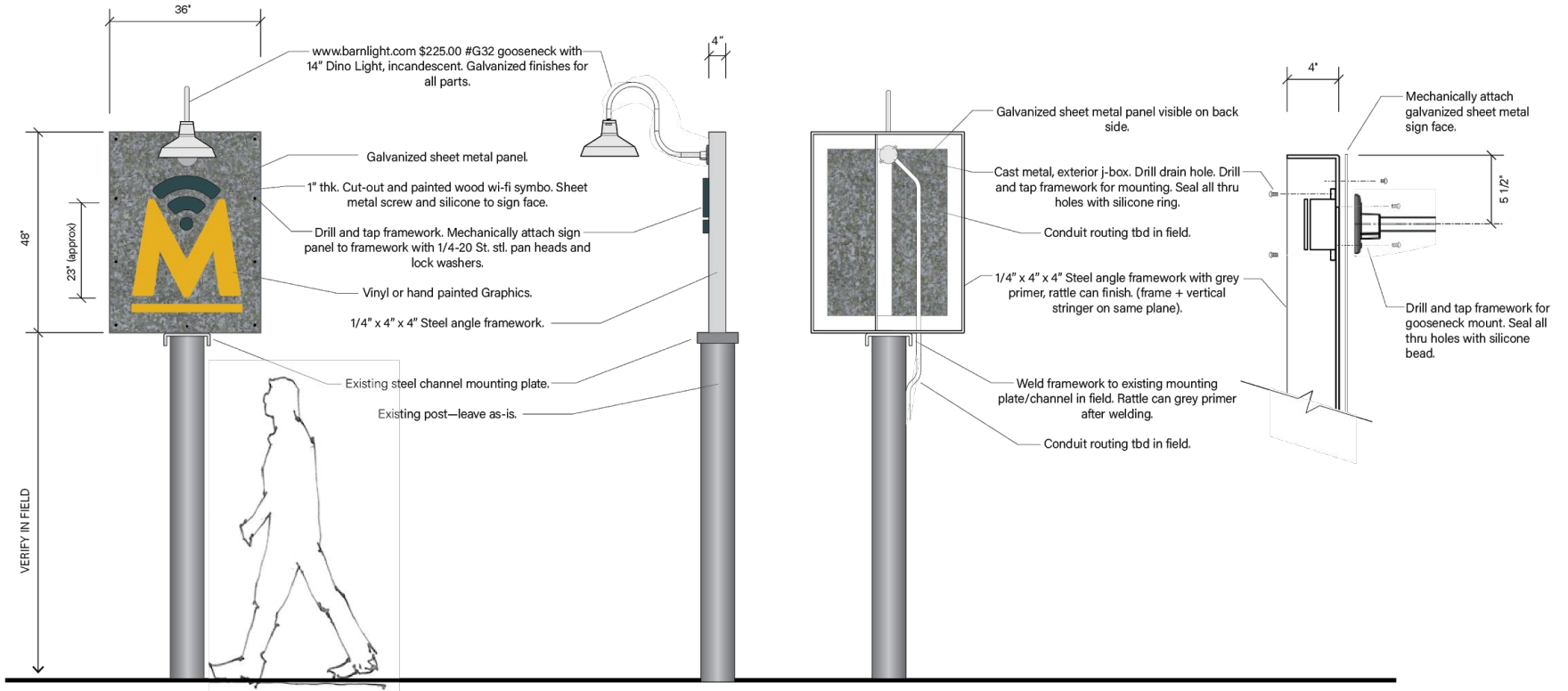

1 ELEVATION: Pole Sign
1/2" = 1'-0"

2 SIDE VIEW: Pole Sign
1/2" = 1'-0"

3 BACK: Pole Sign
1/2" = 1'-0"

4 PARTIAL SECTION
1 1/2" = 1'-0"

CLIPBOARD SIGNAGE PROGRAM

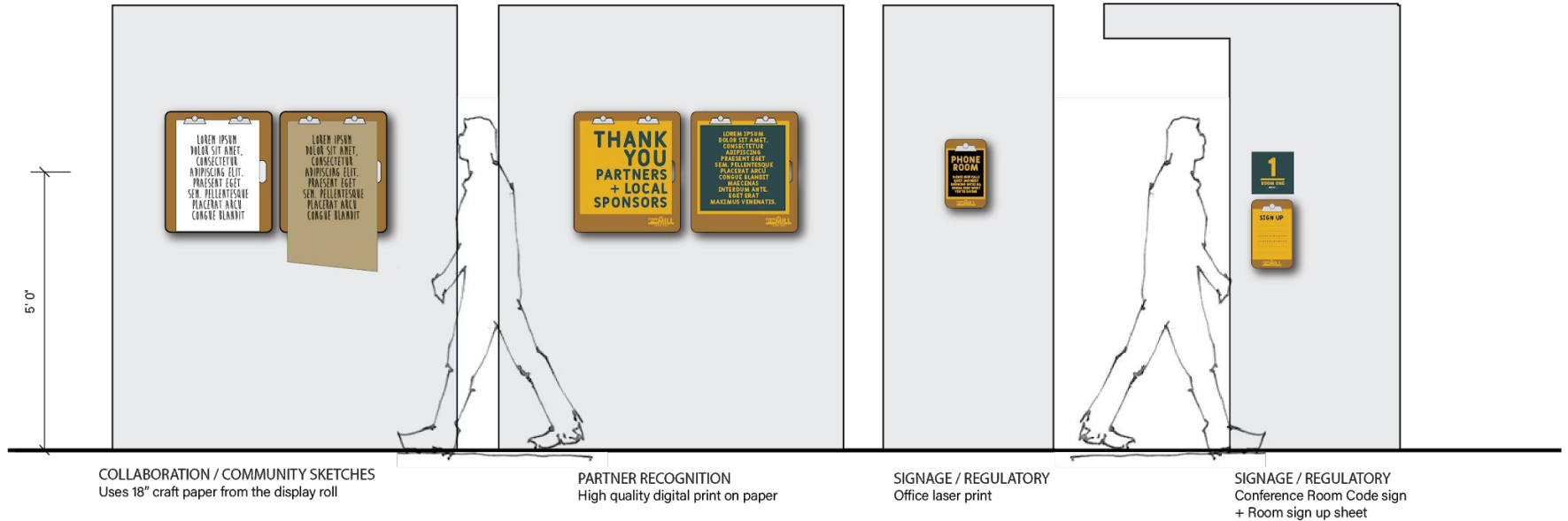

1

ELEVATION: Interior Signage

1/2" = 1'-0"

CLIPBOARD SIGNAGE DETAIL

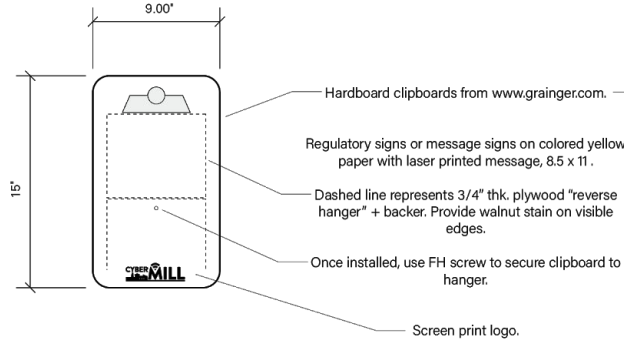
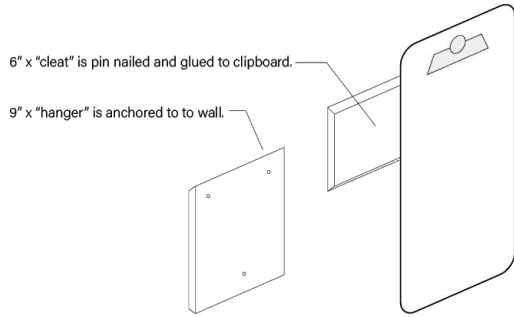

1 ISOMETRIC ASSEMBLY

nts

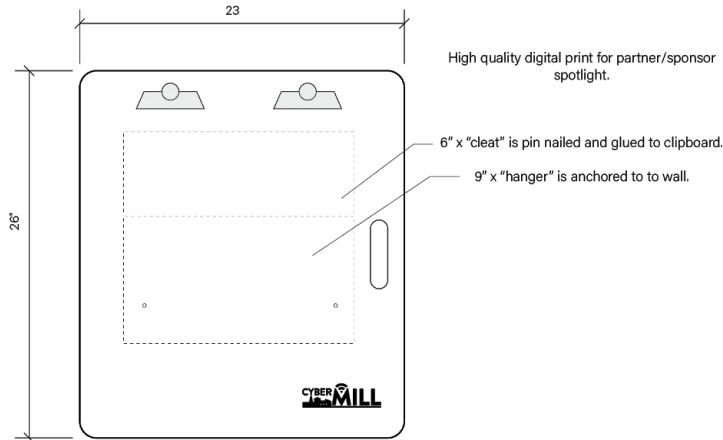

2 DETAIL: Interior Signage

1 1/2" = 1'-0"

CODE SIGNAGE: Simple photopolymer signs that match the brand palette

1 | DETAIL: Men's + Women's Restroom
3" = 1'-0"

2 | DETAIL: Unisex Restroom
6" = 1'-0"

3 | DETAIL: Room Signs
6" = 1'-0"

PROGRAM HUB: A functional focal point where all necessary collateral can be located along with important amenities.

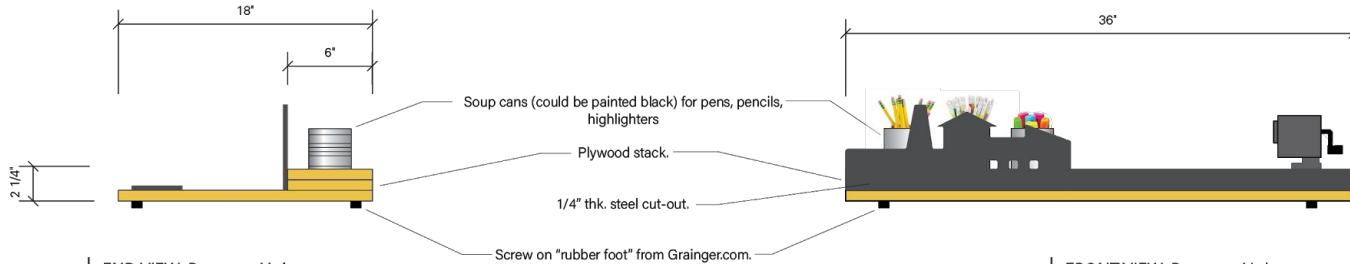

1 END VIEW: Program Hub
1 1/2" = 1'-0"

3 FRONT VIEW: Program Hub
1 1/2" = 1'-0"

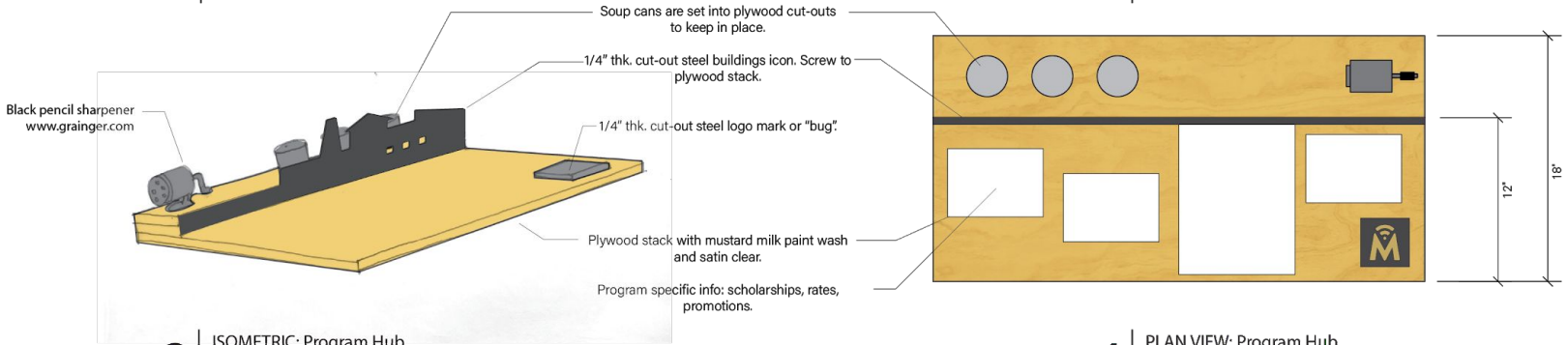

2 ISOMETRIC: Program Hub
nts

4 PLAN VIEW: Program Hub
1 1/2" = 1'-0"

LOCATION(S) EVENTS BOARD: Fabrication Details

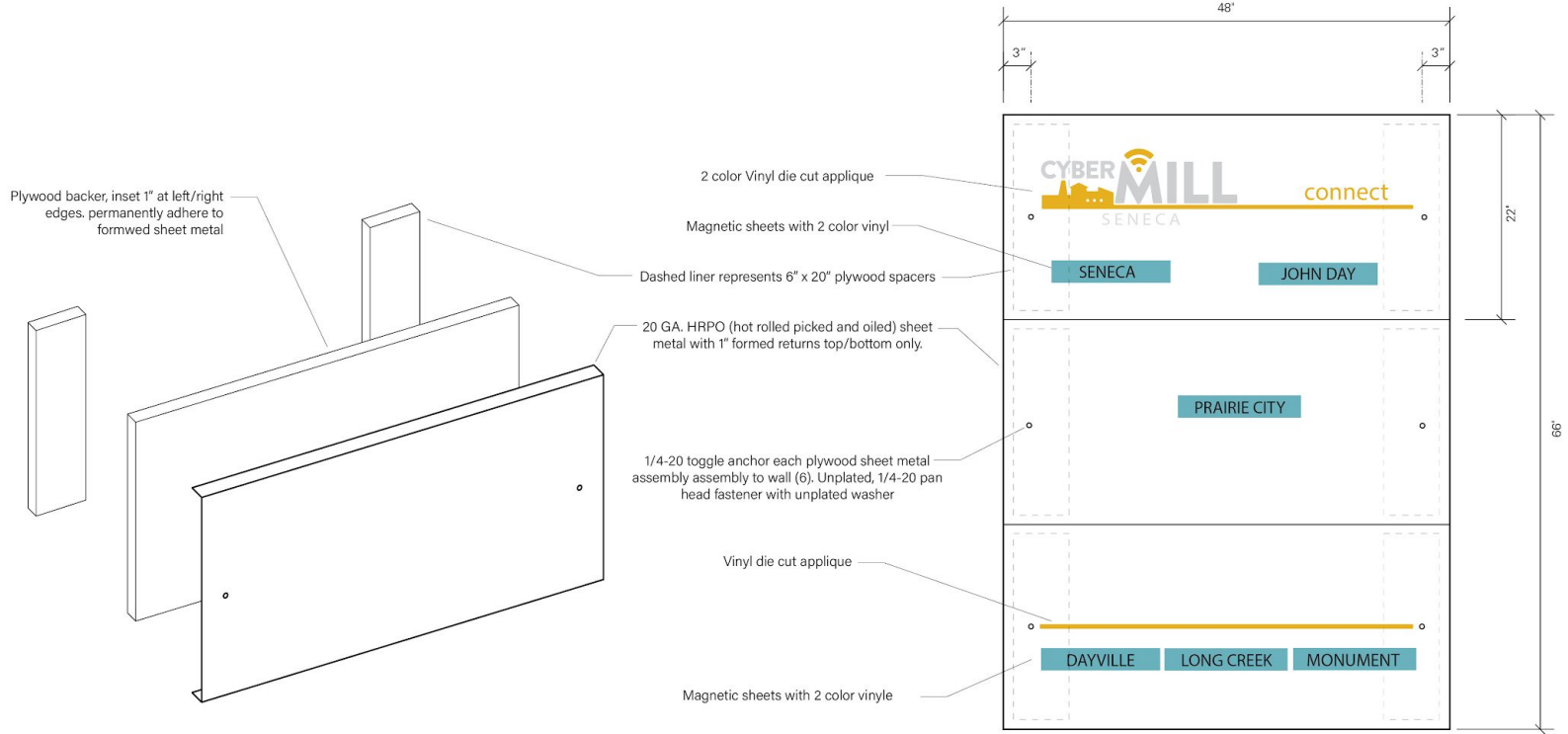

1 | ISO ASSEMBLY: Events board
nts

2 | DETAIL: Events board
1" = 1'-0"

WRITEBOARD + MESSAGE BOARD (PAPER ROLL): Fabrication Details

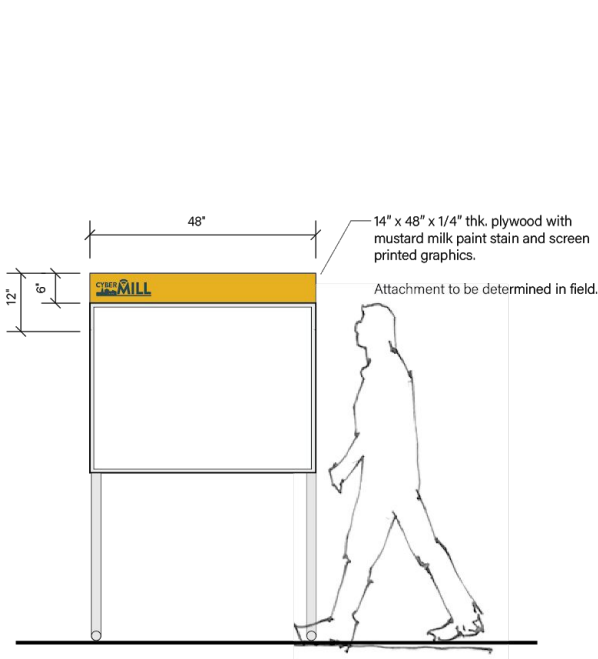

1 | ELEVATION: Write Board
1/2" = 1'-0"

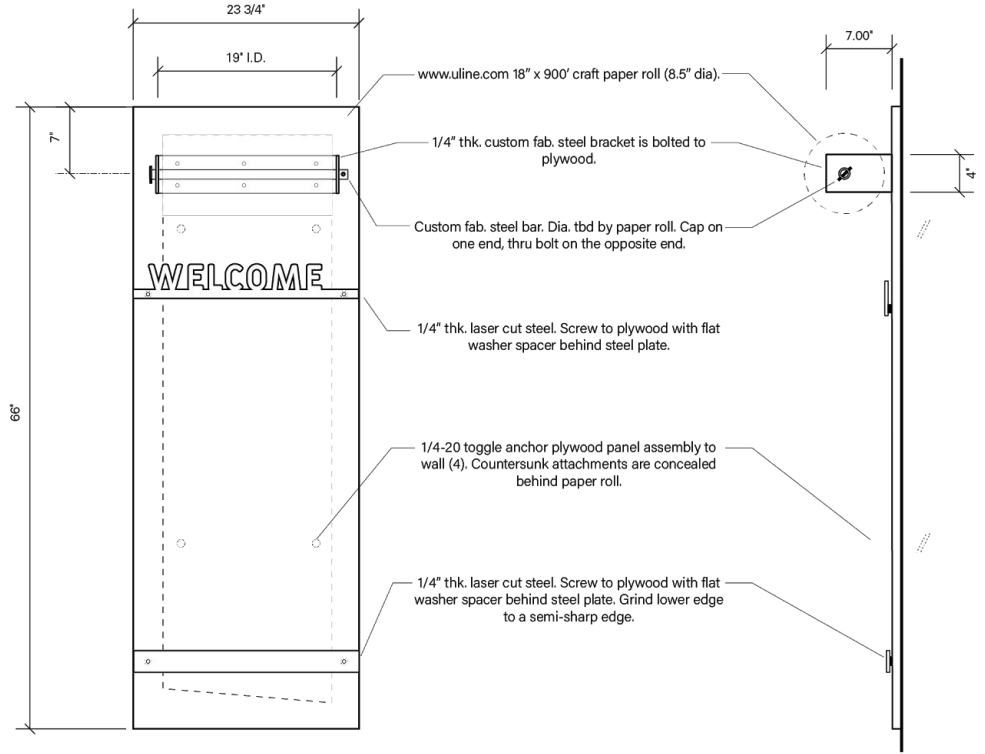

2 | DETAIL: Messaging board
1" = 1'-0"

3 | SIDE VIEW: Messaging board
1" = 1'-0"

CABLE HOLDER AT LOUNGE MONITOR: Fabrication Details

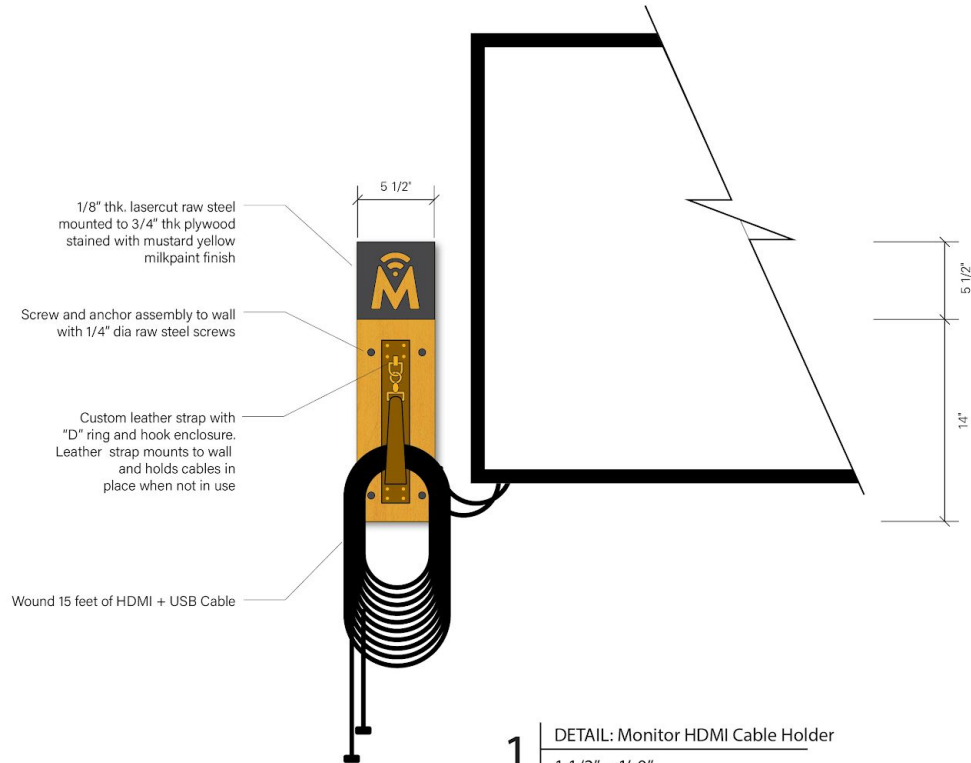

ACOUSTIC ARTWORK: A visual reminder of the splendor of Grant County with a surprising hidden function.

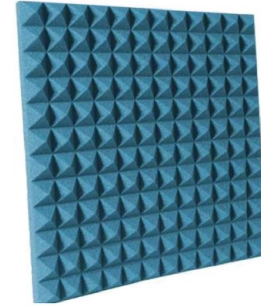
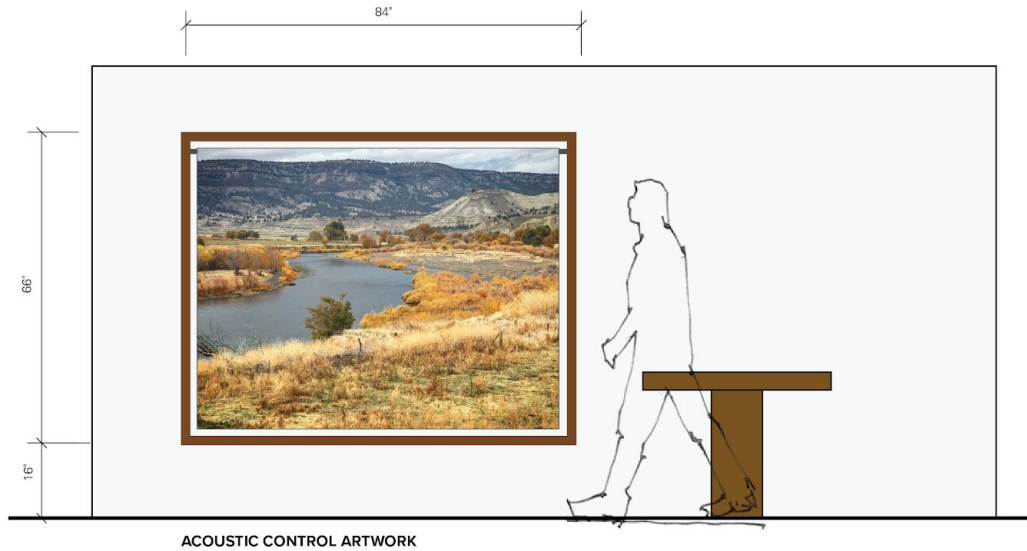

2" thk. Pyramid Acoustic Foam
 24" x 24" panels 18/\$432.00 case
 Six needed per artwork installation
www.soundproofcow.com

1 | ELEVATION: Open Collaboration
 1/2" = 1'-0"

ACOUSTIC ARTWORK: Fabrication Details

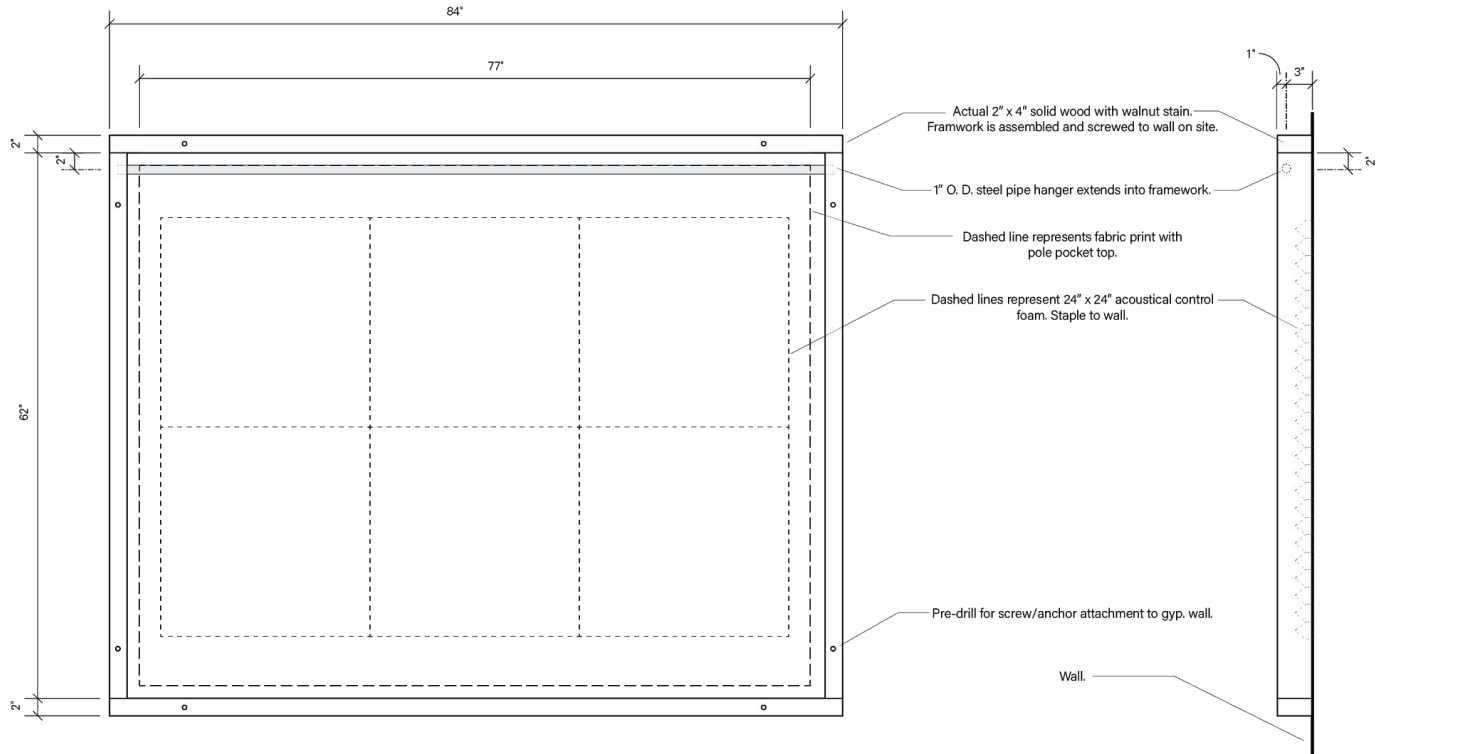

1

DETAIL: Acoustic Control Artwork

1" = 1'-0"

2

SIDE VIEW: Acoustic Control Artwork

1" = 1'-0"

JOHN DAY: Site photos



JOHN DAY: Test fit signage, brand & furniture elements

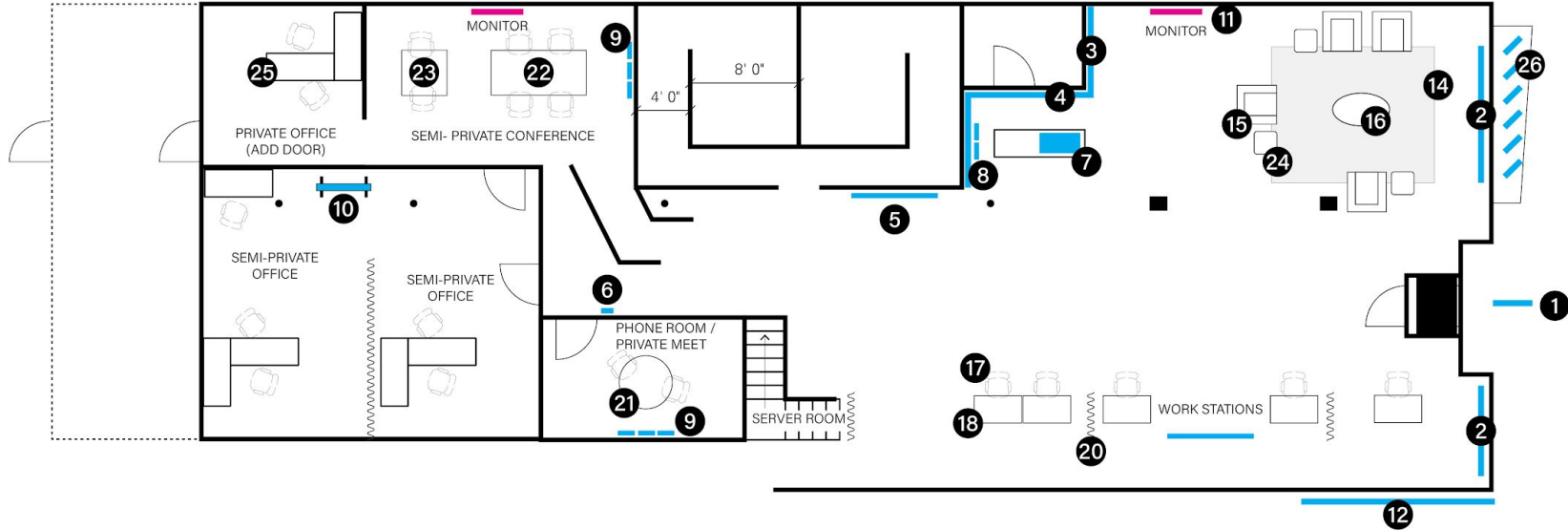

NOTE: Dimensions are unverified/inaccurate. Restroom corridor length is "off" as drawn above (width works with supplied dims).

JOHN DAY: Re-configuring for events / budget

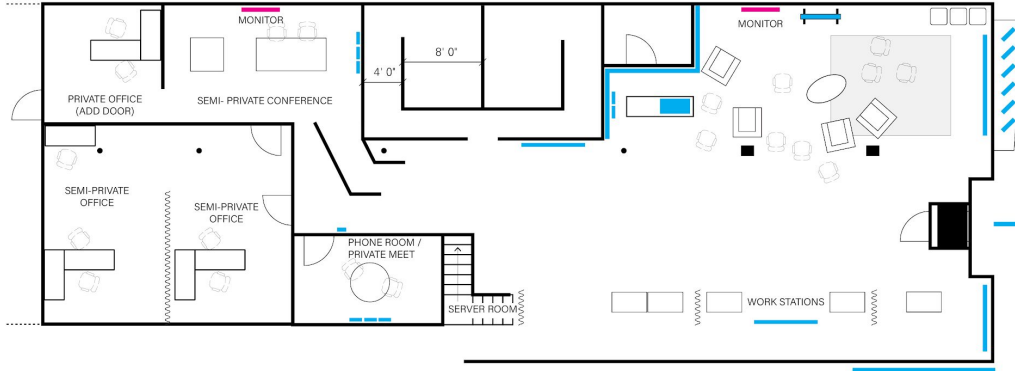

Number	Component	Description	Quantity	Budget	Budget
1	Blade Sign	Double sided, building mounted. Add Barn light(s) above)	1	\$2,500.00	
2	Storefront branding	Window graphics & icons	1	\$500.00	
3	Community + Events Board	Magnetic, identifies all sites	1	\$1,500.00	
4	Welcome + message board	Paper roll panel	1	\$700.00	
5	Thematic backdrop / artwork	Acoustic control artwork	2	\$2,250.00	
6	Phone Booth ID	9 x 15 clipboard panel with message. Assuming other misc. regulatory signage	4	\$600.00	
7	Program Hub	Countertop organizer for pens, pencils, pencil sharpener and program specific flyers	1	\$600.00	
8	Partner / Sponsor ID	23 x 26 clipboard panel with message	2	\$500.00	
9	Community Art or Scribble Panel	23 x 26 clipboard panel	6	\$600.00	
10	Write Board	Metal Porcelain + rollable	1		\$600.00
10b	Write board Branding	1/4" thk. plywood graphic ID element	1	\$400.00	
11	Monitor Cable Hanger	Cut-out metal logo "bug" + leather strap to secure USB + HDMI cords	lot	\$500.00	
12	Building branding	Painted on side of building at large scale. Logo ID + icons	1	\$1,500.00	\$250.00
14	Area Rug	Drawn at 10' x 12' (Minimum)	1		\$300.00
15	Lounge Chairs	Soft Seating. Durable + cleanable	4		\$900.00
16	Coffee Table	Wood 48" x 24" (Oval is ideal)	1		\$200.00
17	Office Chairs		20		\$2,600.00
18	Workstation Desks	24" x 42"	5		\$1,200.00
20	"Phone Booth" Curtain	Closes to create phone booth "privacy" and mitigate sound. Curtain + ceiling track (added \$500 install) https://roomdividersnow.com/products/ceiling-track-room-divider-kits?variant=16602650950	4		\$1,750.00
21	Work Table	Wood 48" diameter. Ideal with single support base	1		\$250.00
22	Conference Table A	40" x 72 - 84" (max 40" width)	1		\$200.00
23	Conference Table B	40" x 40"	1		\$200.00
24	Side Tables	20" x 20" (max)	3		\$300.00
25	Office Desks	24" x 60" (as drawn)	7		\$1,400.00
26	Industrial Artifacts	Composition of elements in landscape planter. verify power to landscape light fixture	lot		\$800.00
				\$12,150.00	\$10,950.00

PRAIRIE CITY: Site photos

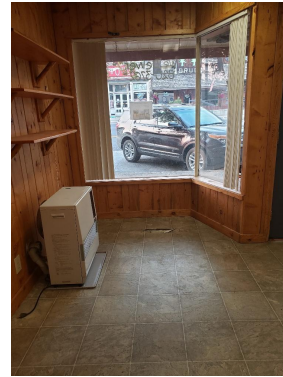

PRAIRIE CITY: Test fit signage, brand & furniture elements + budget

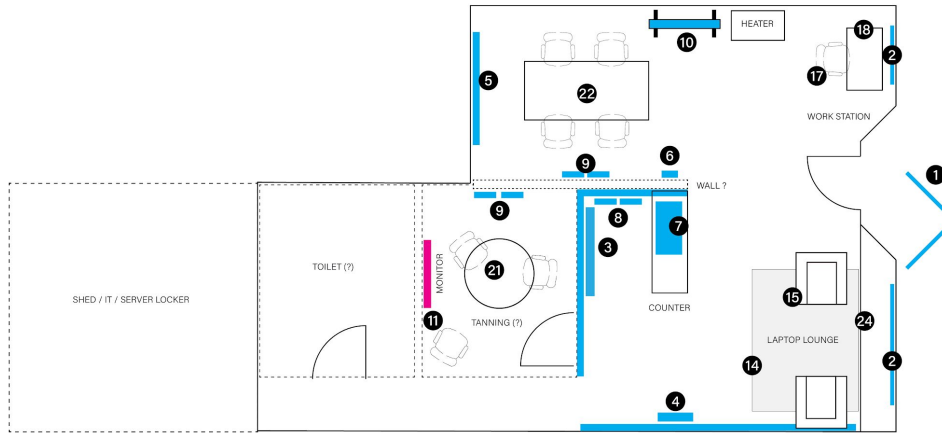

Number	Component	Description	Quantity	Budget	Budget
1	Blade Signs	Re-use existing two, single sided, circular blade signs. Paint and apply new cut-out graphics	2	\$2,000.00	
2	Storefront branding	Window graphics & icons	1	\$500.00	
3	Community + Events Board	Magnetic, identifies all sites	1	\$1,500.00	
4	Welcome + message board	Paper roll panel	1	\$700.00	
5	Thematic backdrop / artwork	Acoustic control artwork	1	\$1,500.00	
6	Community Conference ID	9 x 15 clipboard panel with message. Assuming other misc. regulatory signage	2	\$500.00	
7	Program Hub	Countertop organizer for pens, pencils, pencil sharpener and program specific flyers	1	\$600.00	
8	Partner / Sponsor ID	23 x 26 clipboard panel with message	2	\$400.00	
9	Community Art or Scribble Panel	23 x 26 clipboard panel	6	\$500.00	
10	Write Board	Metal Porcelain + rollable	1		\$600.00
10b	Write Board Branding	1/4" thk. plywood graphic ID element	1	\$400.00	
11	Monitor Cable Hanger	Cut-out metal logo "bug" + leather strap to secure USB + HDMI cords	1	\$500.00	
12	Sidewalk Sandwich Board	Logo ID + Friendly invitation to come inside	1	\$800.00	\$250.00
14	Area Rug	Drawn at 6' x 8'	1		\$300.00
15	Lounge Chairs	Soft Seating, Durable + cleanable	2		\$600.00
16	Coffee Table	Wood 48" x 24" (Oval is ideal)	1		\$200.00
17	Office Chairs		8		\$1,500.00
18	Workstation Desks	24" x 42"	1		\$300.00
21	Work Table	Wood 48" diameter (max.). Ideal with single support base	1		\$250.00
22	Conference Table A	40" x 72 - 84" (max 40" width)	1		\$200.00
24	Built-in side table	Existing	n/a		\$0.00
				\$9,900.00	\$4,200.00

NOTE: Interior floor plan is based on assumptions looking at site photos. No interior dimensions have been supplied.



THANK YOU