

WEST SIDE PARKING LOT

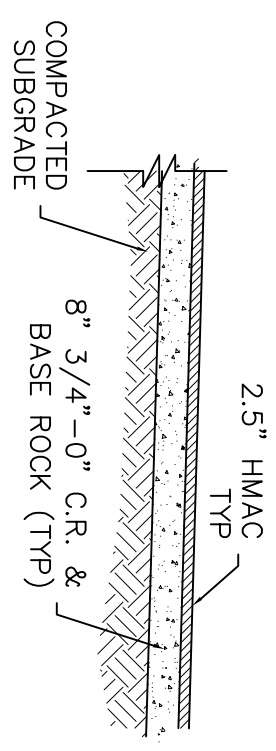
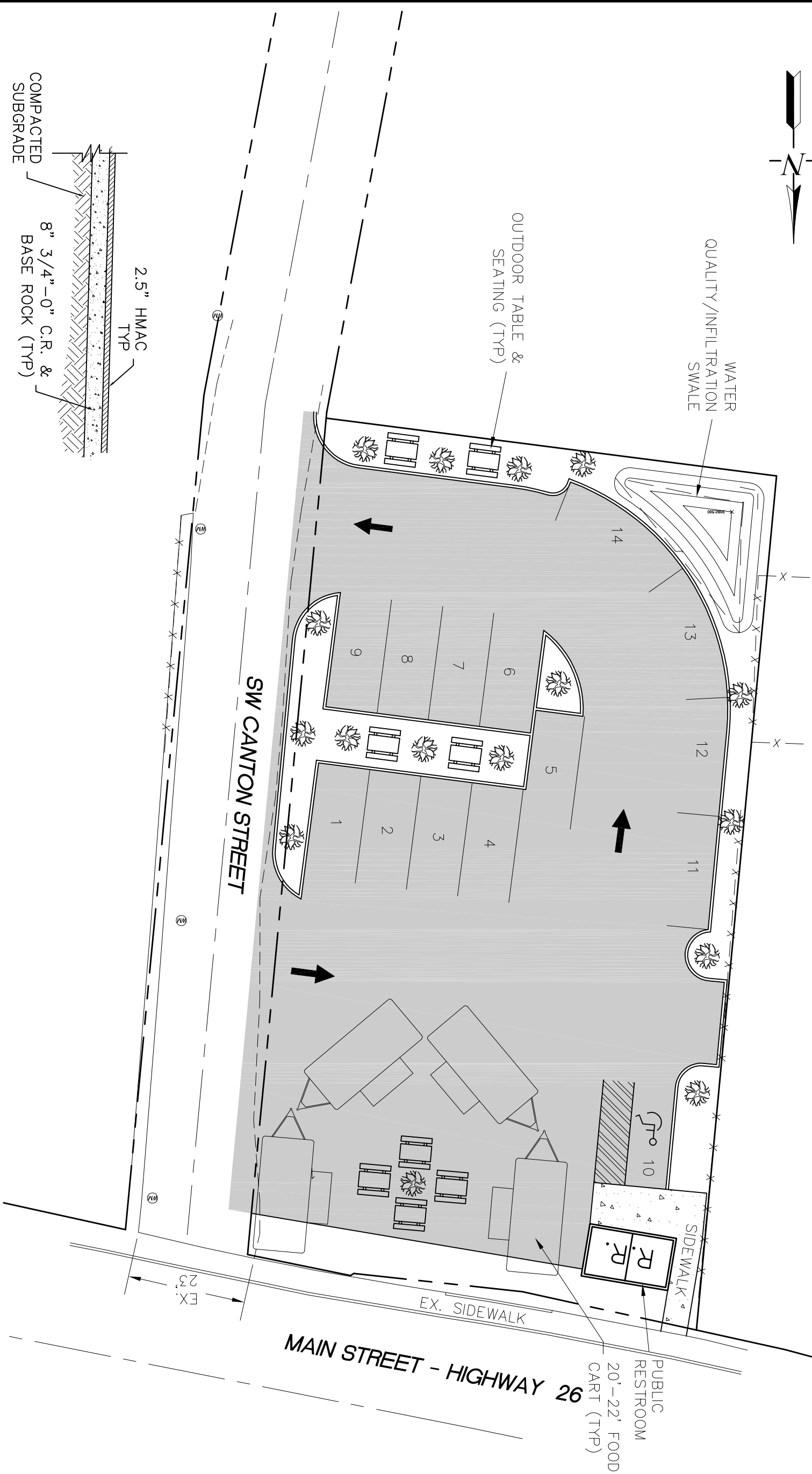

TYP PAVEMENT SECTION
NTS

SW CANTON STREET

MAIN STREET - HIGHWAY 26

PUBLIC RESTROOM
20'-22' FOOD CART (TYP)

SIDEWALK

EX. SIDEWALK

EX. 23'

<p>SISUL ENGINEERING 158 E. MAIN STREET JOHN DAY, OREGON 97845 (541) 575-3777</p>	<p>DOWNTOWN FOOD COURT & PARKING IMPROVEMENTS WEST PARKING LOT</p>	<p>INNOVATION GATEWAY ECONOMIC REVITALIZATION PROJECT CITY OF JOHN DAY, OREGON</p>	<table border="1" style="width: 100%; border-collapse: collapse;"> <tr> <th style="font-size: 8px;">REVISIONS</th> <th style="font-size: 8px;">BY</th> </tr> <tr> <td style="height: 20px;"> </td> <td> </td> </tr> <tr> <td style="height: 20px;"> </td> <td> </td> </tr> <tr> <td style="height: 20px;"> </td> <td> </td> </tr> </table>	REVISIONS	BY						
REVISIONS	BY										
DATE: JAN 2021	SCALE: NOTED	DRAWN: JH	JOB: 20-								
SHEET: 01	OF 01 SHEETS										